

INSTALLATION IN EXISTING CAVITY

DRAWING 1

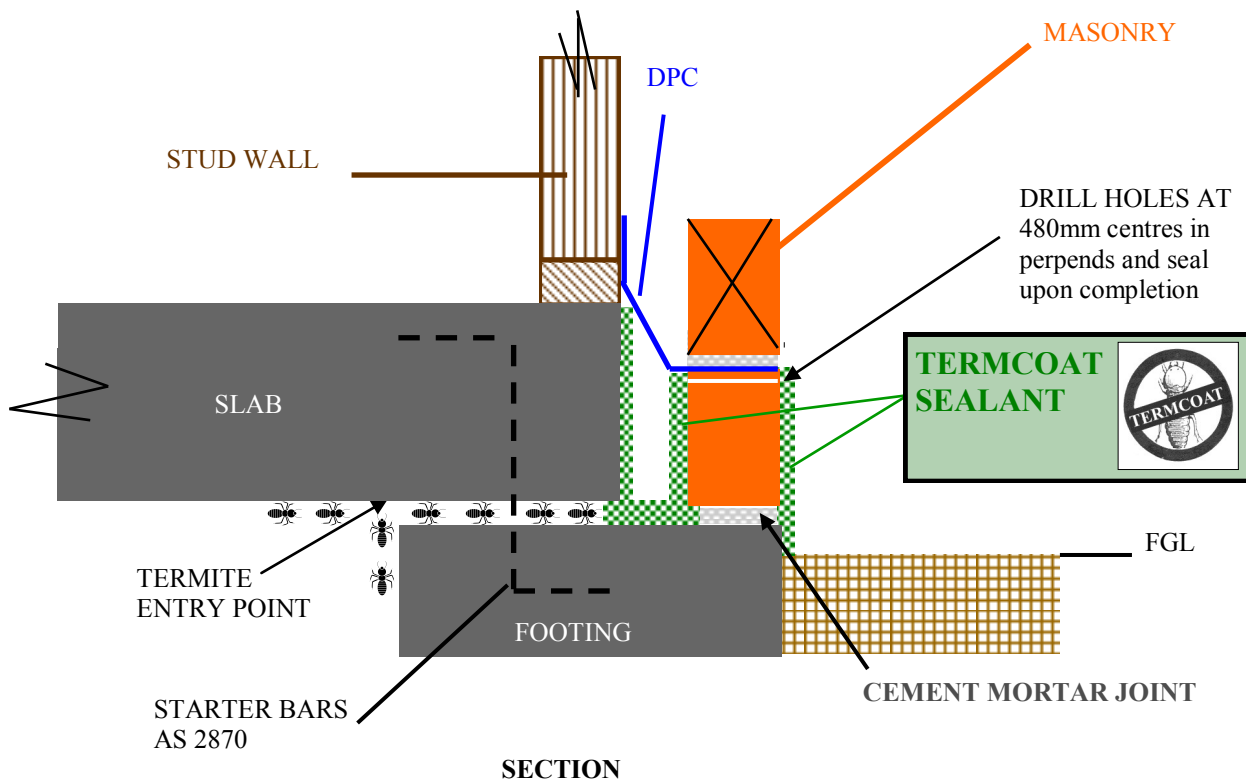

APPLICATION Cavity Drawing 1

Drill holes into masonry joints immediately under the flashing at perpend continually around the perimeter of the building at intervals not exceeding 480mm apart.

Insert application cavity nozzle into the wall cavity for the full distance. Commence spraying while slowly rotating nozzle on withdrawal to ensure all internal surfaces are coated.

Ensure all mortar has been installed in accordance with the Building Code of Australia.

Apply two coats, the first to saturate and penetrate into the mortar and render and all surfaces within the cavity area.

Apply second coat evenly for final finish. Allow to dry before commencement of other trades.

Upon completion plug drill holes with termite resistant sealant or fitted plug and if required provide weep hole protection.

APPLICATION Perimeter Drawing 2 and 3

Mortar Joints: Cement mortar filling of joints, perpends and extrusions with an iron joint finish. Apply two coats, the first to saturate and penetrate into the mortar, render surfaces and base support etc.

Apply second coat evenly for final finish. Allow to dry before commencement of other trades.

Upon completion plug holes with termite resistant sealant or fitted plug.

NOT TO SCALE AND INDICATIVE ONLY

RECTIFICATION OF EXISTING PERIMETER

EXISTING DWELLING THAT HAS HAD PREVIOUS SPRAY TREATMENT OR OTHER TERMITE MANAGEMENT SYSTEM AND NOW HAS INGRESS OF TERMITES THROUGH PERIMETER MASONRY AREA. THIS MAY BE USED IN CONJUNCTION WITH THE CAVITY APPLICATION.

DRAWING 2

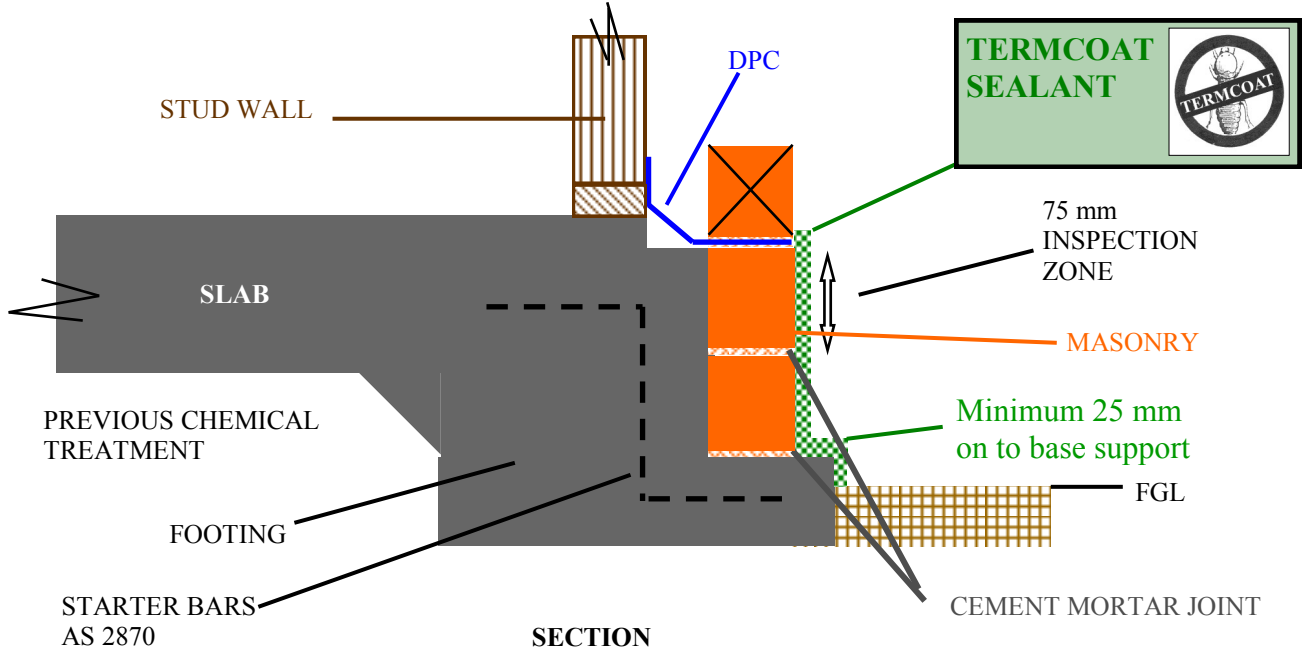

DRAWING 3

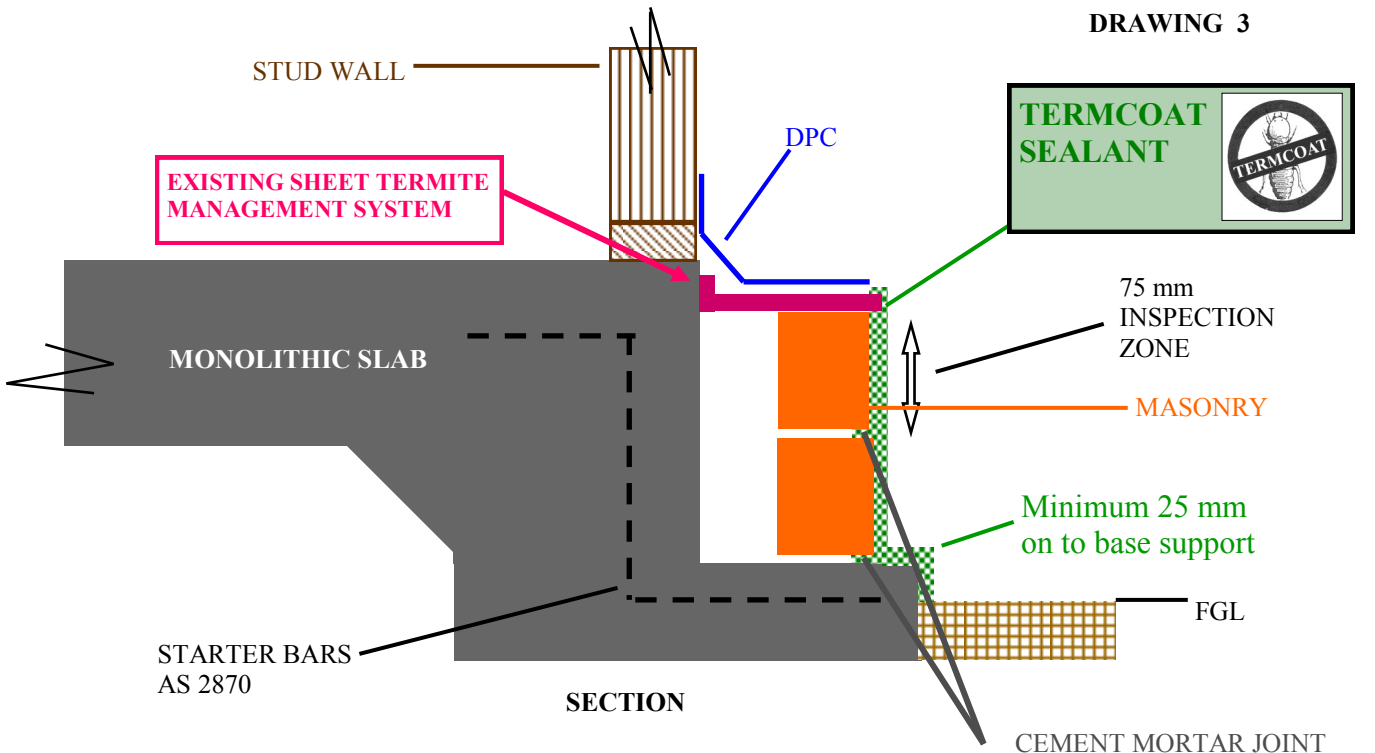

NOT TO SCALE AND INDICATIVE ONLY

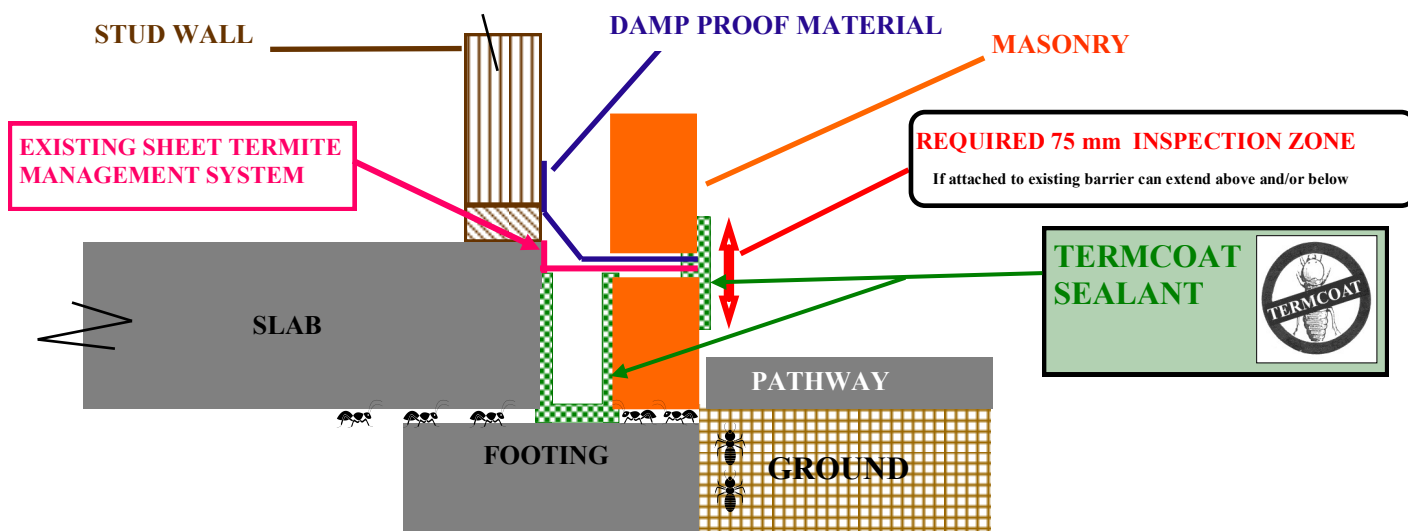

POST CONSTRUCTION

APPLICATION Cavity Drawing

Drill holes into masonry joints immediately under the flashing at perpend continually around the perimeter of the building at intervals not exceeding 480mm apart.

Insert application cavity nozzle into the wall cavity for the full distance. Commence spraying while slowly rotating nozzle on withdrawal to ensure all internal surfaces are coated.

Ensure all mortar has been installed in accordance with the Building Code of Australia.

Apply two coats, the first to saturate and penetrate into the mortar and render and all surfaces within the cavity area.

Apply second coat evenly for final finish. Allow to dry before commencement of other trades.

Upon completion plug drill holes with termite resistant sealant or fitted plug and if required provide weep hole protection.

NOT TO SCALE AND INDICATIVE ONLY